

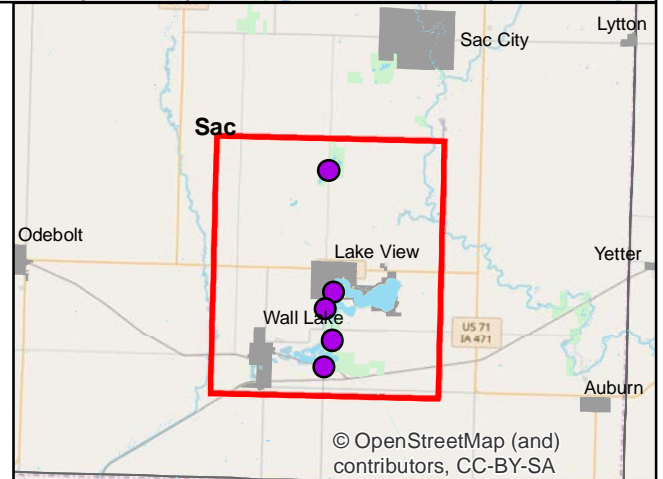

Volunteer Wildlife Monitoring Program (VWMP) Frog and Toad Survey

Route ID: 35 County: Sac

Click for Google Maps to Site 1: <https://www.google.com/maps/dir/?api=1&destination=42.3578340717,-95.0521490463>

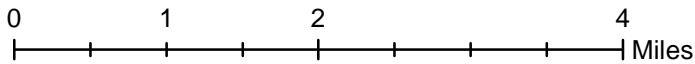
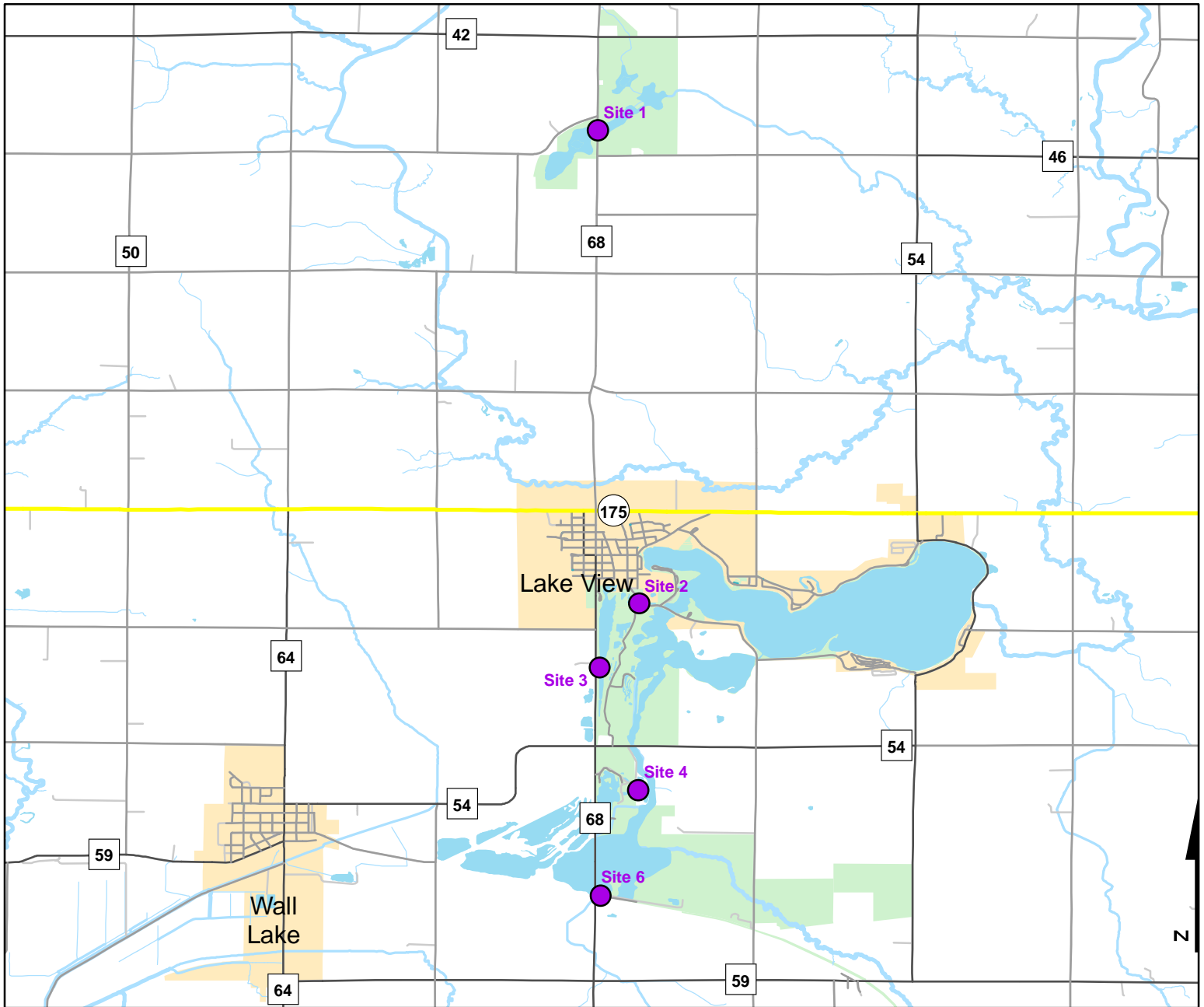



Volunteer Wildlife Monitoring Program (VWMP) Frog and Toad Survey

Route ID: 35 County: Sac

Click for Google Maps to Site 1: <https://www.google.com/maps/dir/?api=1&destination=42.3578340717,-95.0521490463>

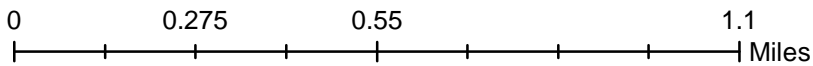
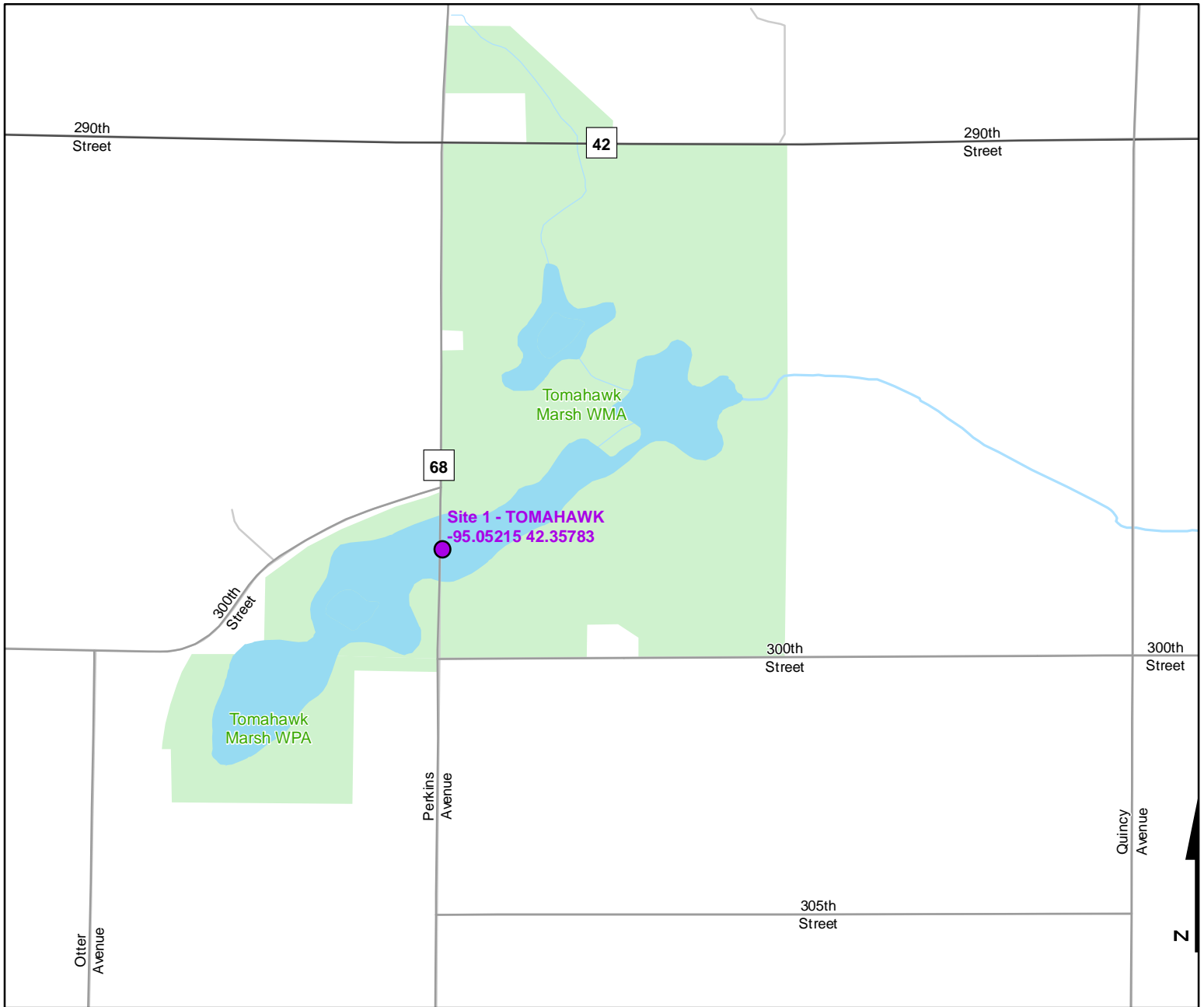

Legend

----- Trails

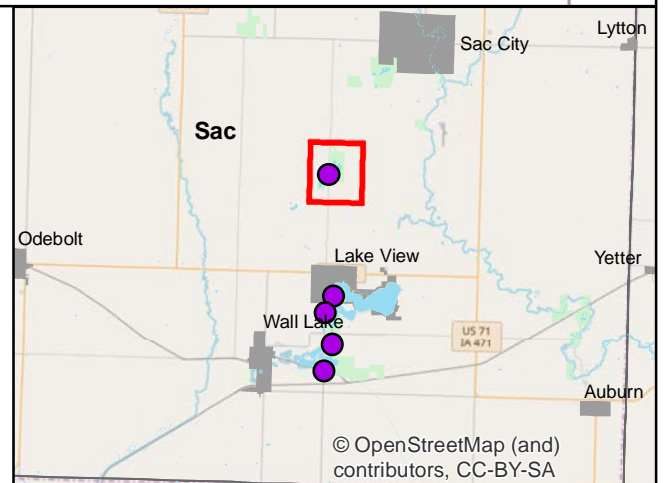



Volunteer Wildlife Monitoring Program (VWMP) Frog and Toad Survey

Route ID: 35 County: Sac

Click for Google Maps to Site 1: <https://www.google.com/maps/dir/?api=1&destination=42.3578340717,-95.0521490463>

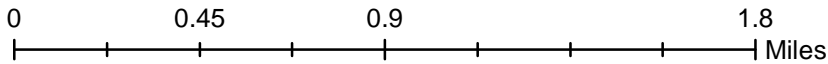
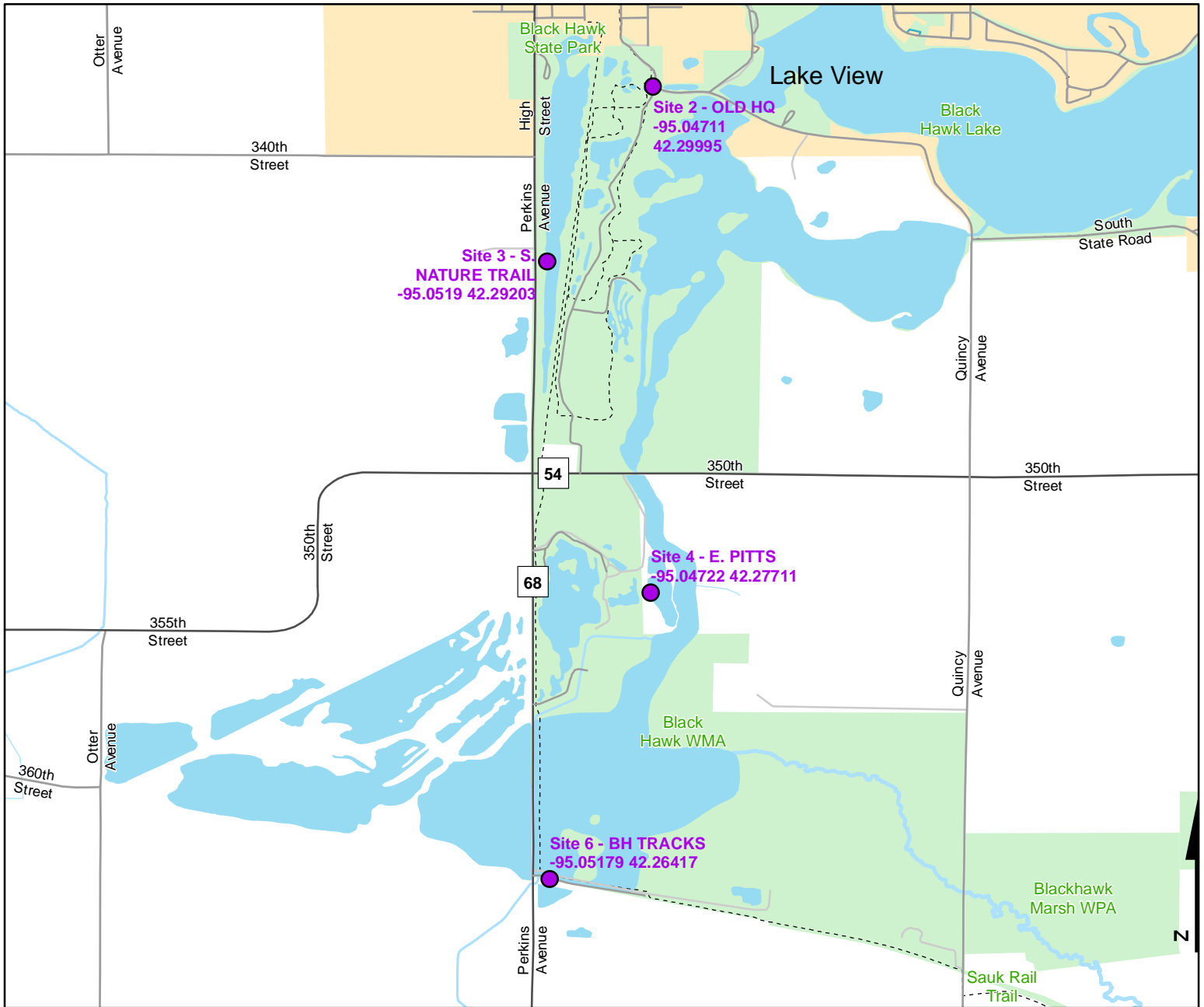

Legend

----- Trails

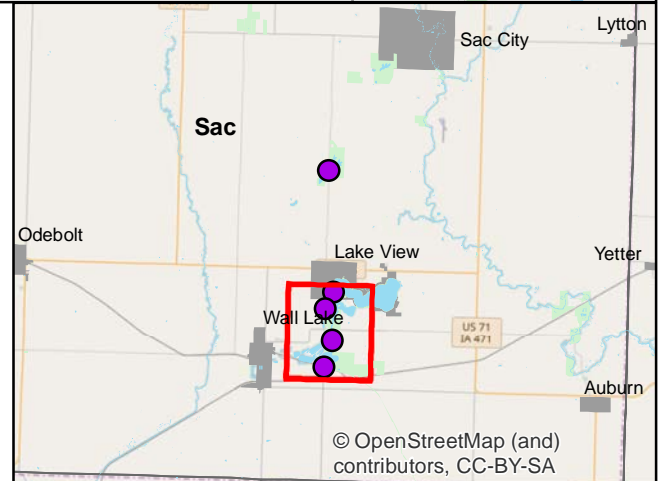

© OpenStreetMap (and) contributors, CC-BY-SA



Frog and Toad Call Survey Route Description

Route ID **35**

Established: 1991

Site Number	Name	County	Latitude	Longitude	Directions
1	TOMAHAWK	Sac	42.3578341	-95.052149	Tomahawk Marsh at culvert tube under Perkins Ave.
2	OLD HQ	Sac	42.299946	-95.0471134	
3	S. NATURE TRAIL	Sac	42.2920345	-95.051903	
4	E. PITTS	Sac	42.2771057	-95.0472226	100 ft. north of fork in access road
6	BH TRACKS	Sac	42.264173	-95.051787	Along Black Hawk Marsh access 200 feet east of road